

# JB1X-PCB Series Junction Box for Obstruction Lights

For connecting 2-4 obstruction lights' power or alarm wires

JB12-PCB



JB13-PCB



JB14-PCB



JB1X-PCB internal view



## OVERVIEW

JB1X-PCB Series junction box is an economical solution for connecting 2-4 obstruction lights' power and/or alarm wires in parallel.

JB1X-PCB consists of a powder-coated aluminum enclosure, internal terminal blocks and 3-5 M20/M25 Nickel-plated brass cable glands. The internal screw-type terminal block is connected in parallel for connecting up to four obstruction lights.



For example, in a typical low intensity obstruction lighting system, there is one OL32D/OL100D double light on top and three OL32S/OL100S, JB14-PCB can be used to connect the four lights' power wires in parallel.

## FEATURES

- Capable of integrating 2-4 obstruction lights' power/alarm wires in parallel
- Aluminum alloy enclosure powder coated provides good weather and corrosion resistance
- Internal terminals parallel-ready, no need of terminal jumpers
- Nickel-plated brass cable glands and o-ring gasket provide IP65 waterproof protection



## SPECIFICATIONS

Item		JB12-PCB	JB13-PCB	JB14-PCB
				
OPERATION	Number of Terminals	15		
	Grounding	Yes		
	Number of ways	3	4	5
	Number of OB Outputs	2	3	4
	Number of OB Inputs	1		
MECHANICAL STRUCTURE	Enclosure Type	Die-casting aluminum		
	Number of Cable Glands	3	4	5
	Size of Cable Glands	M20/M25, Nickel plated brass		
	Protection	IP65		
	Net Weight	0.5KG		
	Dimension (H*W*Depth)	100mm*175mm*68mm	100mm*175mm*68mm	100mm*215mm*68mm
	Mounting	Wall mounting / Cable-tie mounting		
APPLICATION	Applicable for	2 OBL's power wires connecting in parallel to 1 power input or 2 OBL's power alarm wires connecting in parallel to 1 alarm input	3 OBL's power wires connecting in parallel to 1 power input or 3 OBL's power alarm wires connecting in parallel to 1 alarm input	4 OBL's power wires connecting in parallel to 1 power input or 4 OBL's power alarm wires connecting in parallel to 1 alarm input

## ORDERING CODE

### Model

JB12-PCB

JB13-PCB

JB14-PCB

E.g.: JB13-PCB = Junction box, four ways, one input and three outputs

## DIMENSIONS

### JB12

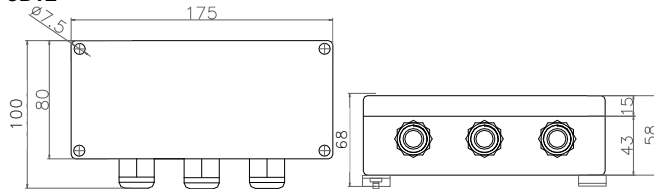

### JB13

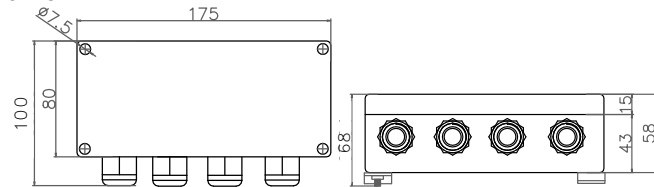

### JB14

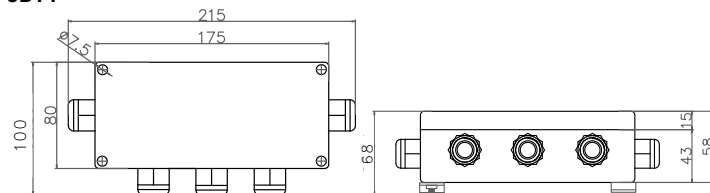

## MOUNTING

### • Wall Mounting

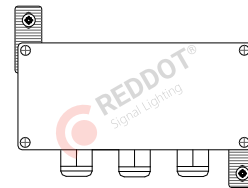

### • Cable-tie Mounting

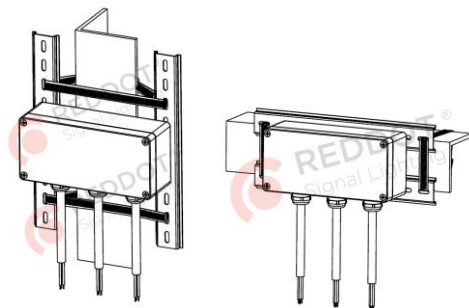

- JB14 junction box connecting one OL32D double and three OL32S single lights

