

OL500 LED Low Intensity Aviation Obstruction Light

•Effective intensity >300cd •Peak intensity >500cd



OVERVIEW

OL500 series low intensity obstruction light is specially designed for countries with a higher aviation standard than ICAO. It is also a perfect low intensity model for foggy or smoggy areas.

OL500 LED module consists of 16 pieces of ultra-bright OSRAM LEDs. REDDOT novel convex lens optimizes photometric performance. Exceeding low intensity standard of ICAO and FAA, its effective intensity is over 300 candelas and peak intensity exceeds 500 candelas. Its visibility is more conspicuous than OL32, OL100 and OL200 at night.

OL500 NVG compatible version with IR LEDs or Red/IR dual LEDs is a night vision solution for pilots being able to view obstruction lights using Night Vision Goggles.

OL500 low intensity obstruction light can be used on top of structures less than 45m. In some cases, OL500 units with multiple OL32/OL100 lights on the middle are capable of marking the outline of a structure.

COMPLIANCE

- Australia CASA Mos Part 139
- UK CAP168 Low Intensity Obstacle (Group B)
- Obstacle Light Low Intensity Type A, Type B and Type E, ICAO Annex 14 Volume I July 2016
- L-810 and L-810F, FAA AC No. 150/5345-43F
- DGAC Mexico

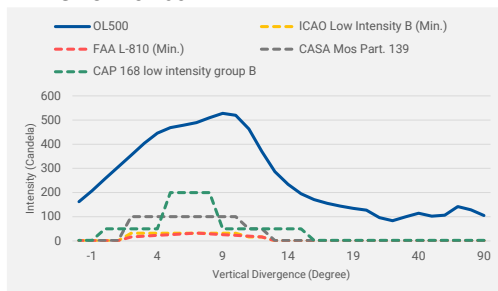

APPLICATIONS

- Telecommunication Tower
- TV/Radio Tower
- Transmission Tower
- High-rise building
- Industrial Chimney & Cooling Tower
- Tower Crane
- Bridge
- Wind turbine
- Airfield & helipad
- Storage tank & Water tower
- Oil & Gas offshore platform

FEATURES

- 16 pcs of super-bright OSRAM LEDs, reliable light source ensures long lifespan
- Novel convex lens enhances photometric performance
- Effective intensity>300cd, peak intensity>500cd
- Internal LED driver and constant current regulator make the light illuminate steadily
- PCB integrated LED module and circuit provide better vibration resistant than E27 type
- GE polycarbonate lens, UV-stabilized
- Aluminum base with powder painted, corrosion-resistant
- Prewired cable for easy wiring job without opening light head
- Protective vent for balancing pressure and reducing condensation
- Built-in 20KA surge protector module to protect the light from induction lightning strike
- NVG compatible with IR LEDs or Red/IR dual LEDs available
- Optional functions available: built-in photocell/alarm relay/flasher/GPS
- A handle on the light shoulder makes carrying and lifting easier for deployment
- Protection: Polarity reverse, overvoltage and shortcircuit
- IP67 waterproof protection



■ SPECIFICATIONS

Item		OL500 Specifications
LIGHT OUTPUT	Effective Intensity	>300cd (Peak intensity>500cd)
	Vertical beam	>10°
	Horizontal Spread	360°
	Light Source	OSRAM LEDs
	LED Color	Red
	LED Lifespan	100,000 Hours
OPERATION	Flash Pattern	Steady or flashing 20-60FPM
POWER SUPPLY	Input Voltage	85-265VAC, 50-60Hz / 48VDC / 24VDC / 12VDC
	Power Consumption	27W@steady, 9W@flashing
MECHANICAL STRUCTURE	Lens	Polycarbonate, UV Stabilized
	Body	Aviation yellow powder-coated extruding aluminum
	Mounting	Four 16*25mm slot holes on bottom 200 mm PCD
	Net Weight	4.5KG
	Dimension(W*H)	235mm*175mm
	Protection	IP67
	Operation Temperature	-40°C~+70°C
	Operation Humidity	0-95% RH non-condensing
	Wind resistance	Max.240kph
OTHERS	Optional	<ul style="list-style-type: none"> •Built-in photocell •Dry alarm contacts (NO&NC) •GPS •NVG compatible with IR LEDs
	Warranty	5 years

■ ORDERING CODE

Main P/N	Voltage	Flashing	Photosensor	Alarm Relay	NVG Compatible	GPS
OL500S	A220 (85-265VAC)	[Blank] (Steady)	[Blank] (without photosensor)	[Blank] (without Alarm Contacts)	[Blank] (only RED LEDs)	[Blank] (Without GPS)
	A120 (85-265VAC)	F (Flashing)	P (with photosensor)	R (with Alarm Contacts)	NVG (only IR LEDs)	GPS (With GPS)
	D48 (48VDC)				RED-NVG (dual Red/IR LEDs)	
	D24 (24VDC)					
	D12 (12VDC)					

E.g.: OL500SA220FPR = LED low intensity obstruction light, 85-265VAC, red flashing>500, with built-in photocell and alarm relay

■ DIMENSIONS

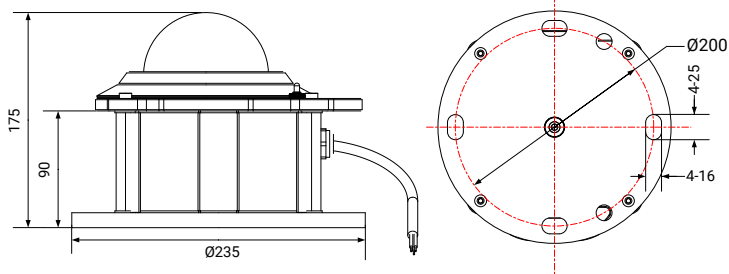

■ MOUNTING

• U-bolt mounting

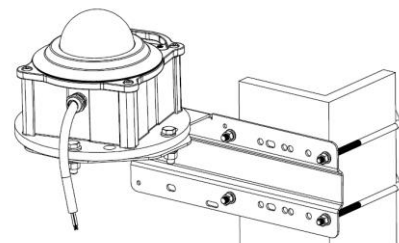

AMP30150-VB bracket (U-bolt holders) for dia.30-150mm angular/tubular structures

