

PHC01 Series Photocell for Obstruction Lights

Photocell for Direct AC/DC Power



Photocell for REDDOT OB Controller



OVERVIEW

PHC01 series photocell is used to switch ON&OFF obstruction lights automatically from dusk to dawn.

In a typical obstruction lighting system with a control box, the photocell detects the ambient lux value to trigger the control box to auto-switch ON and OFF the connected obstruction lights.

In an obstruction lighting system with an external photocell, the PHC01 photocell connects both obstruction lights and power supply. The photocell automatically switches ON and OFF obstruction lights via detection ambient lux value.

FEATURES

- Automatically turn obstruction lights on at night and off at day
- Delay response prevents false switching due to surrounding light interference
- Regulated voltage and diode maintain accurate switch points
- 3-core prewires for AC and DC photocell
- 5 meters pre-wired shielded cable for photocell connected to REDDOT controller
- Twist-locking type with locking sock for easy replacement



SPECIFICATIONS

Item		PHC01 Specifications
OPERATION	Input voltage	110-240VAC / 48VDC / 24VDC/ 12VDC
	Power consumption	0.5W
	Sensing type	Photosensor
	ON&OFF Level	70/100lux
	Maximum Load	1000W / 1800VA
	Lifecycle	2000 times ON&OFF
	Delay time	3-5 seconds
MECHANICAL STRUCTURE	Enclosure material	Phloycarbonate, UV stabilized
	Mounting plate	Aluminum
	Prewires	3-core wires for direct AC/DC power, 5meter 2*1sqmm shielded cable for adapting REDDOT control box
	Protection	IP54 for direct power type, IP65 for control box type
	Net Weight	0.5KG
	Dimension (H*W)	220*80mm
	Mounting	Wall mounting / couduit mounting
Warranty	Warranty	1 year

ORDERING CODE

Series	Input Voltage
PHC01	A220 (110-240VAC) D48 (48VDC) D24 (24VDC) D12 (12VDC) [BLANK] (FOR REDDOT CONTROL BOX USE)

E.g.: PHC01A220 = Photocell 10-240VAC, incl photocell head, bracket and socket
PHC01 = Photocell, IP65, for REDDOT control box, with 5m 2*1sqmm prewired shielded cable

DIMENSIONS

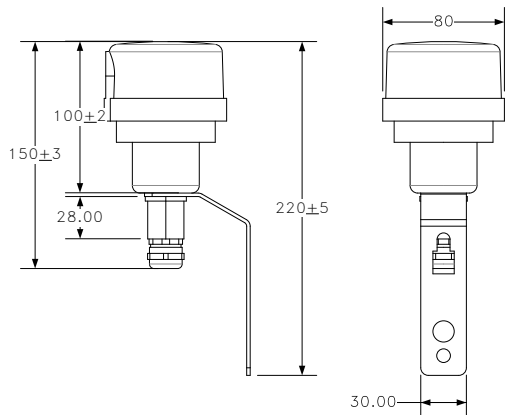

MOUNTING

Wall Mounting

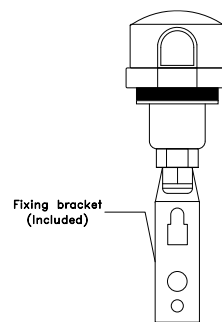

Conduit Mounting

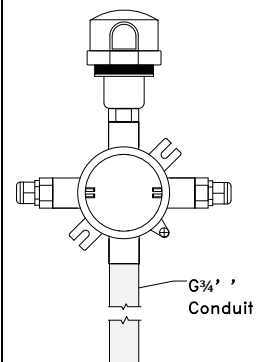

APPLICATION EXAMPLES

- PHC01 photocell controlling one OL32D double and two OL32S single lights

